

Included with the Alumination Soffit and Wall Panels families are detail components and repeating detail components for use with these products. The Soffit Planks are Revit Ceiling Families, and the Wall Panels are Revit Wall Families. Standard 3", 4", 6", and 8" wide planks by 24 feet length.

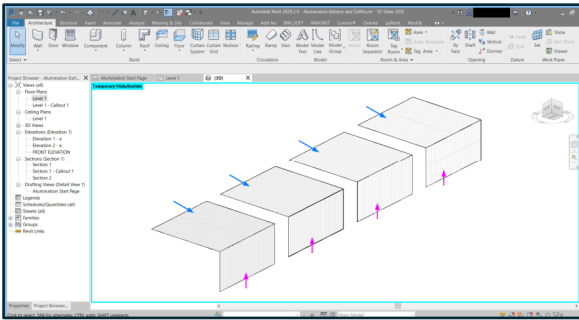

1. MODEL CONTENT

- The Soffit Planks are ceiling families with model fill patterns.
- The Wall Panels are wall families with model fill patterns.
- The fill patterns can be aligned however a use desires.
- Revit ceiling families and wall families can be used for both interior and exterior purposes.
- Both soffit and wall panels require a trim piece on the edge.
- To achieve this, user may use the split face command in Revit to draw/model the edge trim in elevations.

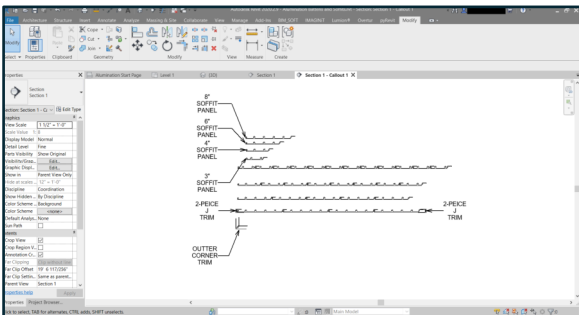

2. DETAIL & REPEATING DETAIL COMPONENTS

- Also provided are detail components with preloaded type comments information and detail component tags for consistent naming and tagging.
- Detail Components Provided:
 - 8" Panel Section Detail
 - 6" Panel Section Detail
 - 4" Panel Section Detail
 - 2" Panel Section Detail
 - 2 - Piece J Trim Section Detail
 - Outer Corner Trim Section Detail
- Repeating Details Provided:
 - 8" Panel Section Detail
 - 6" Panel Section Detail
 - 4" Panel Section Detail
 - 2" Panel Section Detail

3. ORGANIZATION & ALIGNMENT

- Have your own pattern ideas?
- Consult with Alumination to see what's possible.
- Done!

